

DBA200XA20

UL; E76102

《特長》

- ・大電力2素子入り絶縁型パッケージ (SOT-227)
- ・低損失・高速駆動可能
- ・低逆電流 $I_R \leq 10.0\text{mA}$ ($T_j = 150^\circ\text{C}$)
- ・低温電圧 $V_{FM} \leq 1.05\text{V}$
- ・高速ソフトリカバリー $t_{rr} \leq 50\text{ns}$ (typ.)

《用途》

- ・スイッチング電源、溶接機、通信用電源、各種電源装置

《Advantages》

- ・2 diodes in 1 isolated package (SOT-227)
- ・High power, high speed and low loss control
- ・ $I_R \leq 10.0\text{mA}$ ($T_j = 150^\circ\text{C}$)
- ・ $V_{FM} \leq 1.05\text{V}$
- ・ $t_{rr} \leq 50\text{ns}$ (typ.)

《Applications》

- ・Switching power supply, Welding power supply, power sources for communication and various power supplies

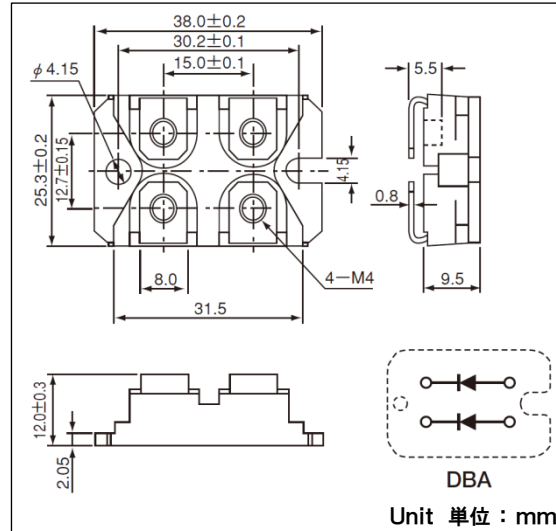

■ Maximum Ratings

(T_j=25°C unless otherwise specified, per diode)

Item	Symbol	Unit	DBA200XA20
Repetitive Peak Reverse Voltage	V_{RRM}	V	200
Reverse D.C. Voltage	$V_{R(DC)}$	V	200

Item	Symbol	Unit	Ratings	Conditions
Average Forward Current	$I_{F(AV)}$	A	100	D.C., T _C =97°C
Surge Forward Current	I_{FSM}	A	1000/1100	1/2cycle, 60Hz, Peak value, non-repetitive
I ² t (for fusing)	I ² t	A ² s	5000	Value for one cycle surge current
Junction Temperature	T _j	°C	-40~+150	
Storage Temperature	T _{stg}	°C	-40~+150	
Isolation Voltage(R.M.S.)	V_{ISO}	V	2500	A.C. 1minute
Mounting torque	Mounting M4	N·m (kgf·cm)	1.5	Recommended Value 1.0~1.4
	Terminal M4		1.5	Recommended Value 1.0~1.4
Mass		g	30	Typical value

■ Electrical Characteristics

(T_j=25°C unless otherwise specified, per diode)

Item	Symbol	Unit	Ratings			Conditions
			Min.	Typ.	Max.	
Reverse Current	I_R	mA			10.0	$V_R=V_{RRM}$, T _j =150°C
Forward Voltage Drop	V_F	V		0.95	1.05	$I_F=100\text{A}$, Inst. measurement
Reverse Recovery Time	t_{rr}	ns		50	60	$I_F=100\text{A}$, $V_R=100\text{V}$, $-di/dt=200\text{A}/\mu\text{s}$
Reverse Recovery Peak Current	i_{rr}	A		5.0	6.5	
Reverse Recovery Charge	Q_{rr}	nC		150	195	
Reverse Recovery Time	t_{rr}	ns		75		$I_F=100\text{A}$, $V_R=100\text{V}$, $-di/dt=200\text{A}/\mu\text{s}$ T _j =150°C
Reverse Recovery Peak Current	i_{rr}	A		10.5		
Reverse Recovery Charge	Q_{rr}	nC		430		
Thermal Resistance	$R_{th(j-c)}$	°C/W			0.5	Junction to case

順特性
Forward Characteristics

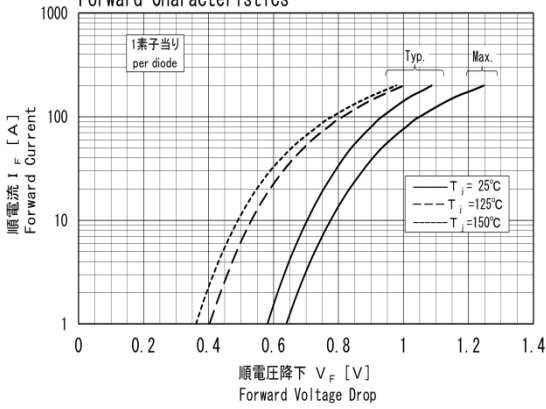

逆回復特性
Reverse Recovery Characteristics

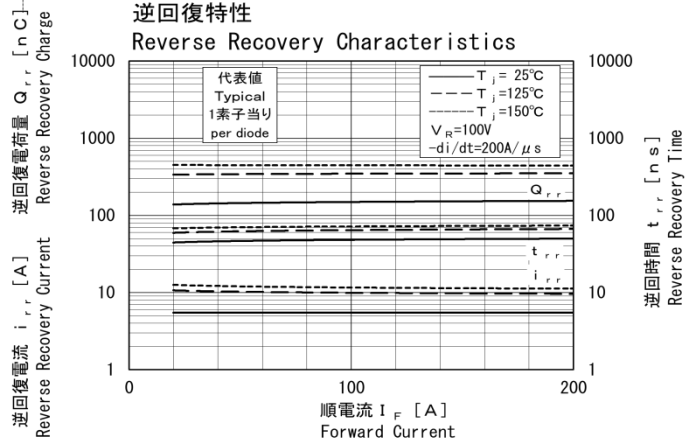

逆回復特性
Reverse Recovery Characteristics

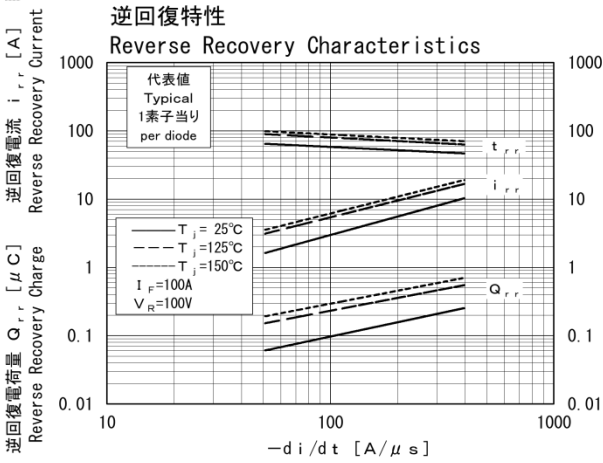

過渡熱インピーダンス特性
Transient Thermal Impedance

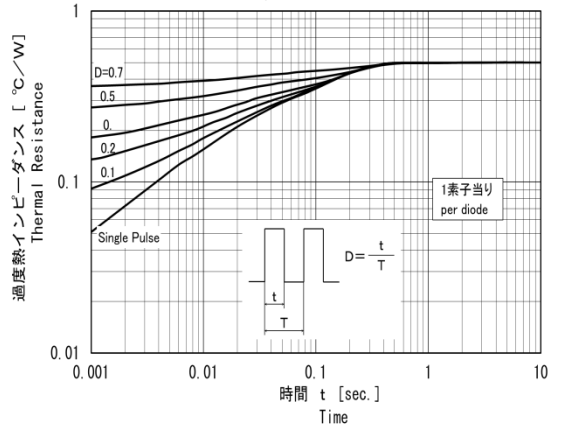

サージ順電流耐量《非繰り返し》
Cycle Surge Forward Current Rating 《Non-Repetitive》

